

Erdgeschoss

Dachgeschoss

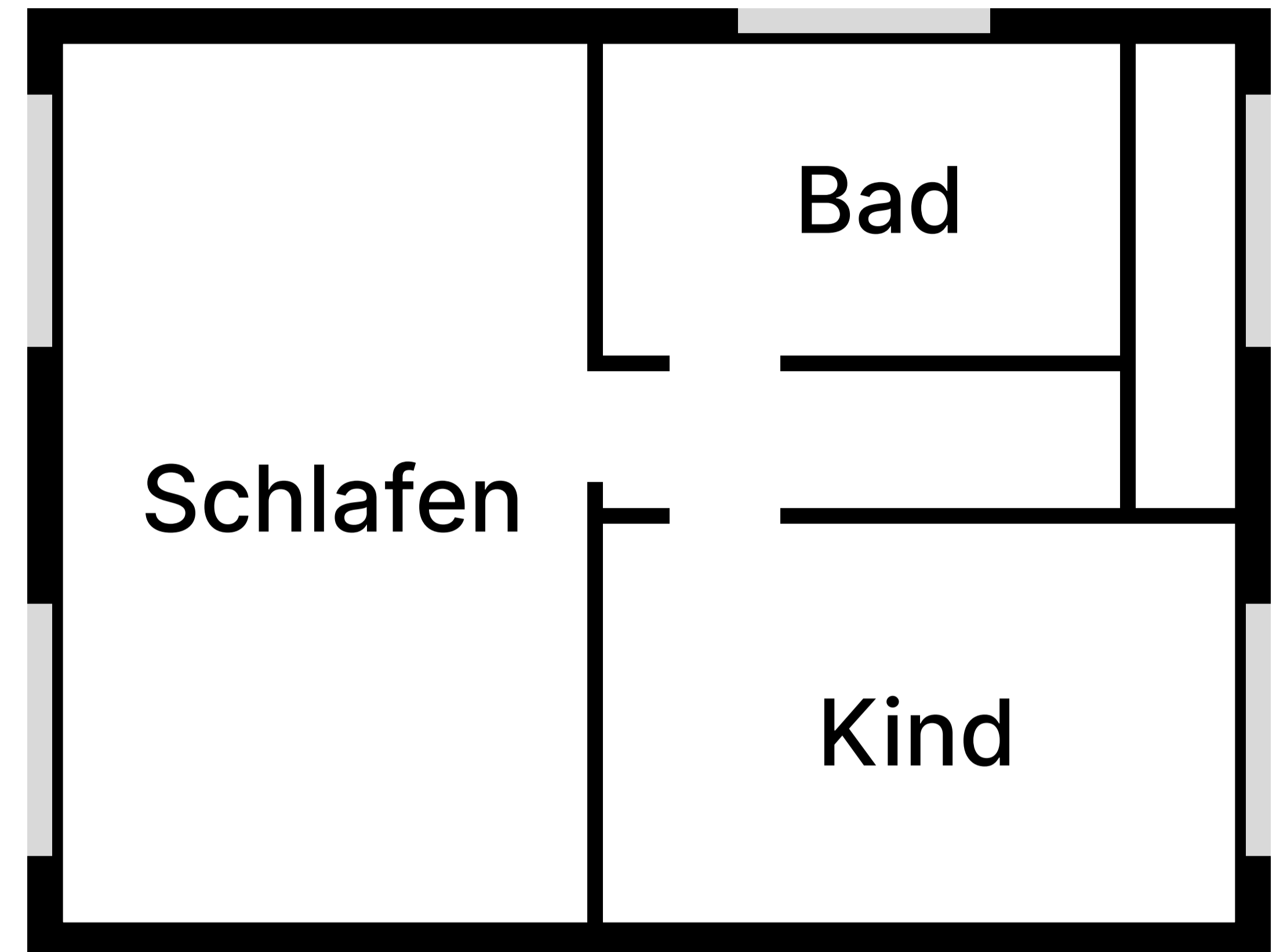
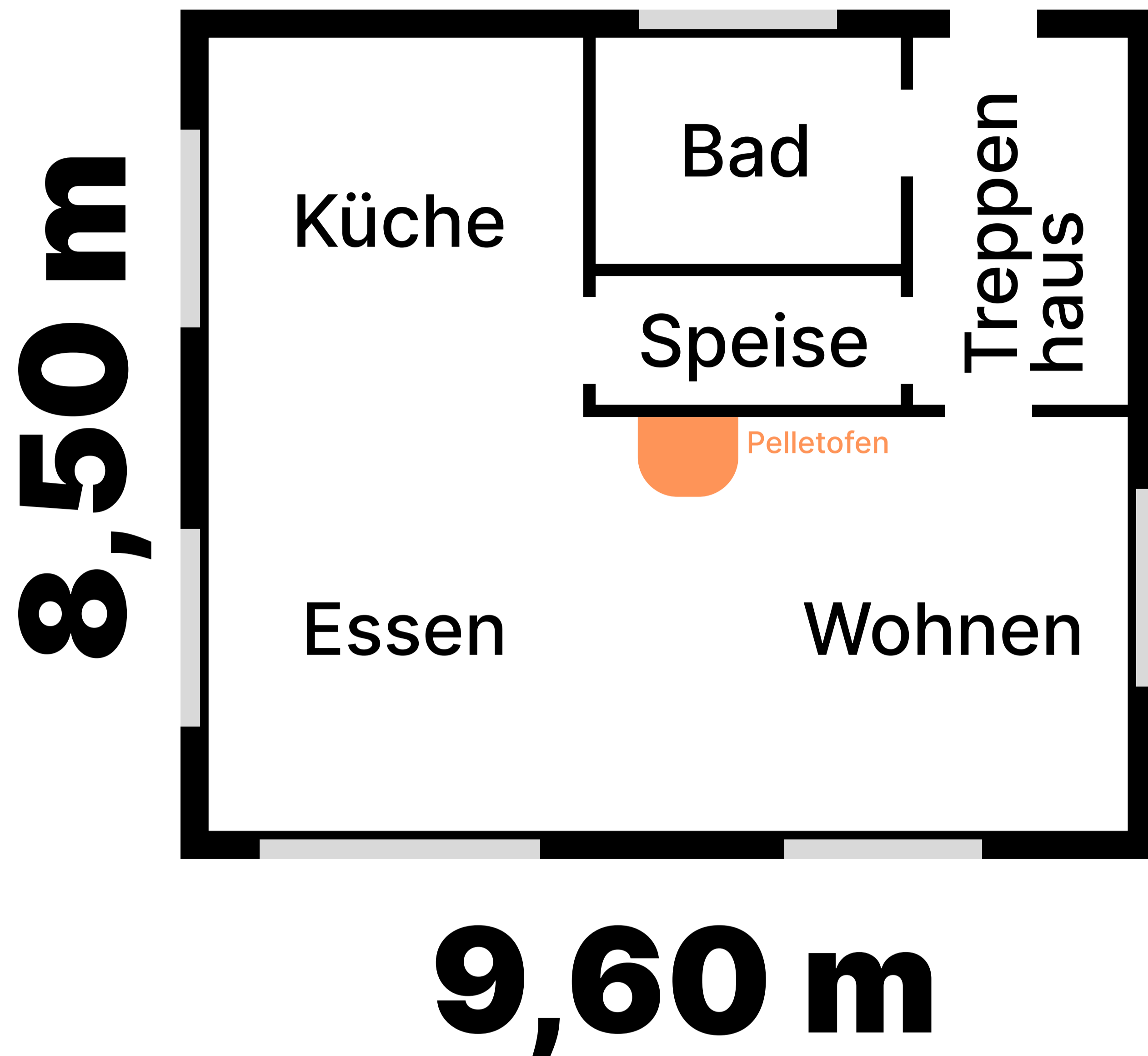

Wände

Außenwand, massiv, Hohlblocksteine - 123,52 m²

- 1,0 cm Kalkgipsputz, $\lambda:0,700\text{W/mK}$

- 30,0 cm Bimshohlblocksteine, $\lambda:0,560\text{W/mK}$

- 1,5 cm Putz, $\lambda:0,870\text{W/mK}$

Berechneter Endenergiebedarf:

61.177 kWh/a

Ermittelter Endenergieverbrauch:

13.319 kWh/a